

# VM P2 series Quick Installation Guide

Application to VM 600/700/800/900/1000 -P2 microinverters

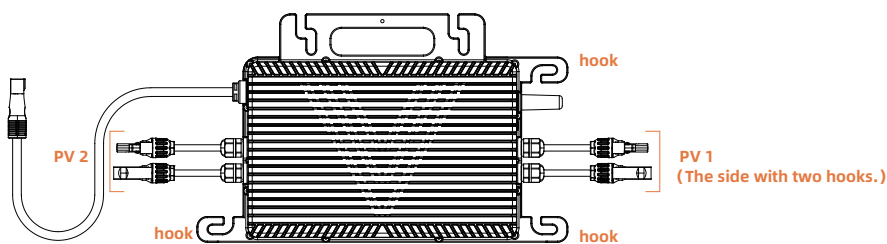

Tools: Allen key, wrench

## 1. Plan and Install the Microinverter

### Plan:

- The installation and DC connection of the microinverter must be set under the PV module to avoid direct sunlight, rain exposure, snow accumulation, ultraviolet radiation and other conditions.
- Leave a minimum of 2 cm of space around the microinverter enclosure to ensure ventilation and heat dissipation.
- Mounting the M8 screw, torque is 5 N·m. Do not over torque.

### Installation:

- Fix the screws on the rail according to the PV module layout.
- Hang the microinverter on the screws, and tighten the screws. The label side of the microinverter should be facing the panel.

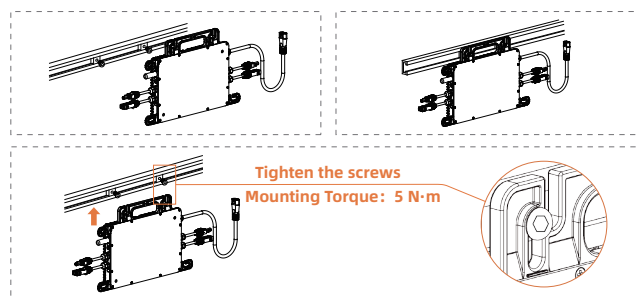

## 2. Complete the AC Connection

- Plug the AC Sub Connector of the microinverter into the AC Connector until you hear the click.

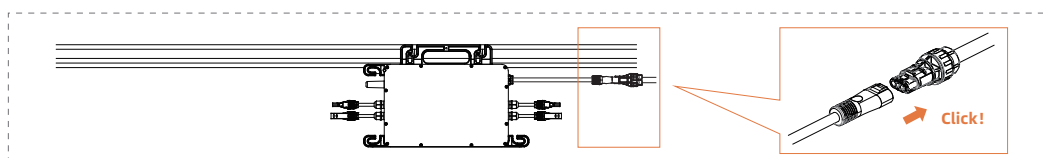

- Connect the AC end cable to the distribution box, and wire it to the local grid network.
- Please plug the AC Port in vacant AC Port to make it water-proof and dust-proof.



### Note:

- Make sure that the AC Trunk Connectors are kept away from any drainage channels.
- In case you need to remove the microinverter AC cable from AC Trunk Connector, insert the AC Trunk Port Disconnect Tool into the side of AC Sub Connector to complete the removal.

## 3. Create an Installation Map

- Peel the removable serial number label from each microinverter.
- Affix the serial number label to the respective location on the installation map (please refer to the appendix).

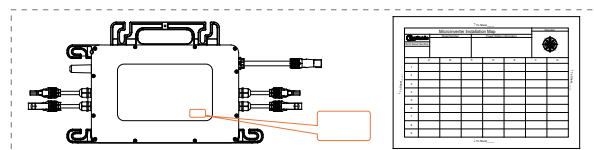

## 4. Connect PV Modules

- Mount the PV modules above the microinverter.
- Connect the PV modules DC cables (MC4) to the DC input of the microinverter.

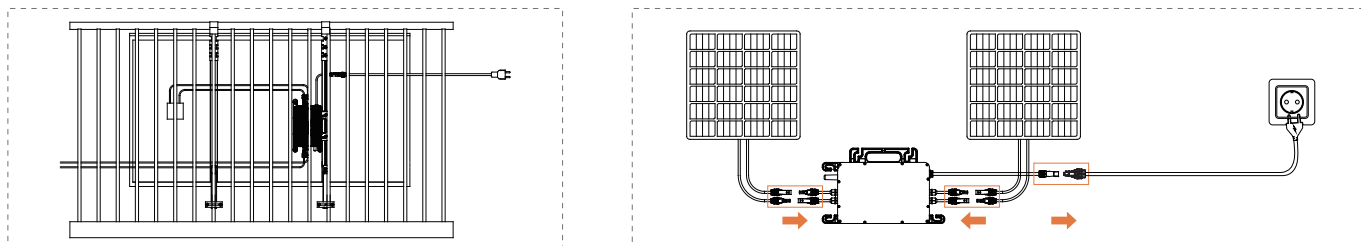

## 5. Set up Monitoring System

- Please download the "VaySunic Cloud" from the App Store / Google Play .
- Please refer to the "Quick Installation Guide for VaySunic Cloud" to set up monitoring system.

